



Long Chaulden, Hemel Hempstead, HP1 2HX

£1,600 PCM

Clements Estate Agents are proud to market this, split-level, THREE bedroom flat. Benefiting from being decorated throughout, multiple storage spaces, good room sizes, close to shops and amenities. Upon entry, you will be greeted by a hallway leading to the spacious lounge / diner, separate to the kitchen. The first floor of the property comprises of a brand new bathroom, TWO double bedrooms, one of which benefits from built in wardrobe space and a single bedroom. This delightful home is available from early May. Call now to avoid disappointment!

External



Living Room 17'0" x 11'11" (5.18m x 3.63m)



Kitchen 9'9" x 2'9" (2.97m x 0.84m)



Bedroom 1 11'9" x 8'6" (3.58m x 2.59m)



Bathroom 7'1" x 6'8" (2.17 x 2.04)

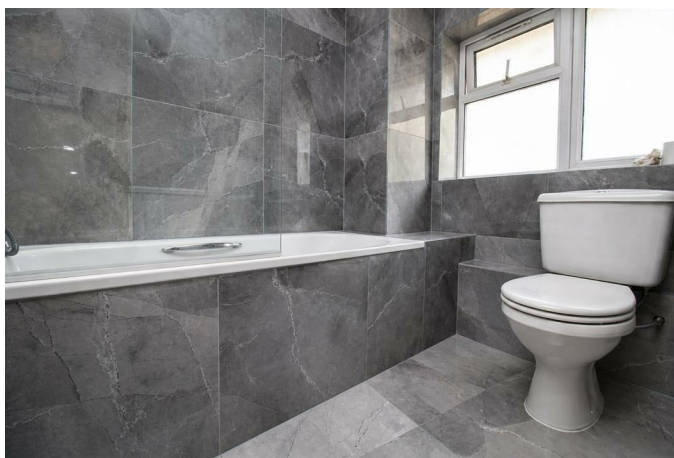

Bedroom 2 11'9" x 8'7" (3.58m x 2.62m)



Bedroom 3 11'10" x 5'7" (3.61m x 1.70m)



Floor Plan

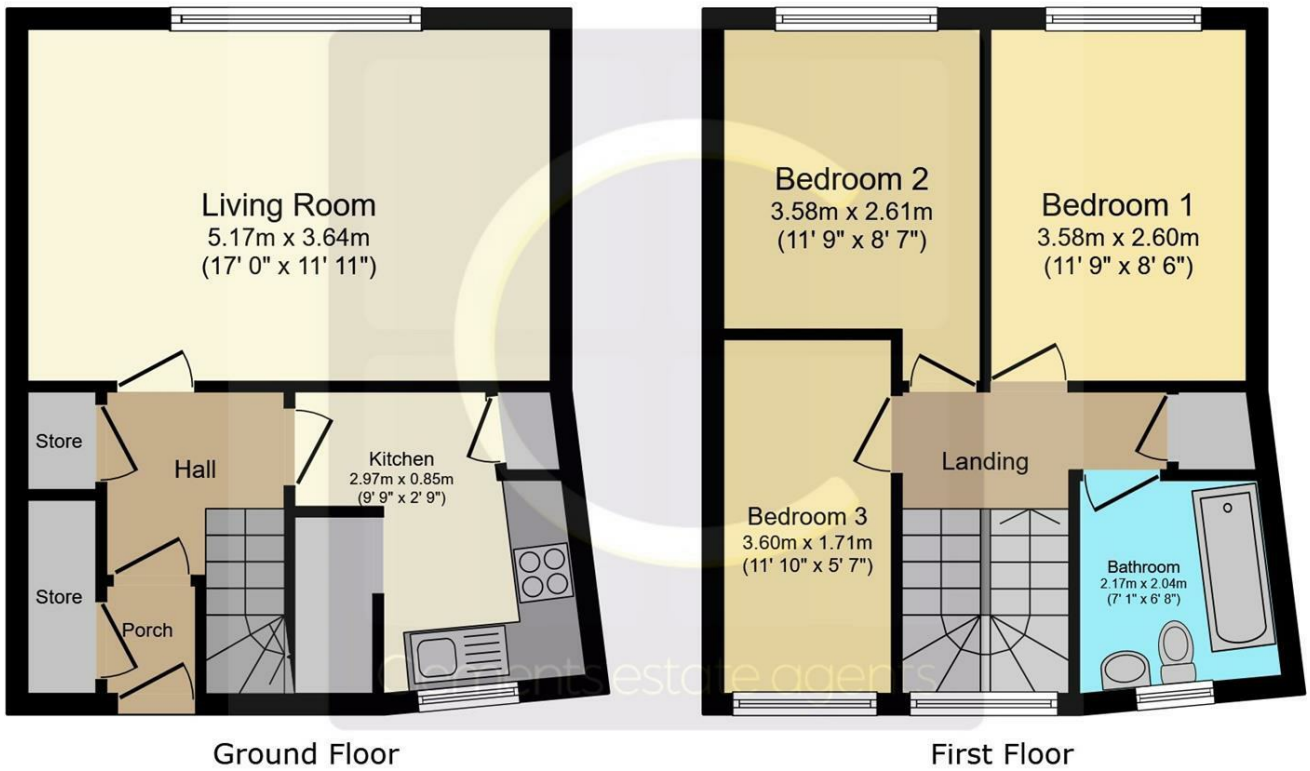

This floor plan is for illustrative purposes only. It is not drawn to scale. Any measurements, floor areas (including any total floor area), openings and orientations are approximate. No details are guaranteed, they cannot be relied upon for any purpose and do not form any part of any agreement. No liability is taken for any error, omission or misstatement. A party must rely upon its own inspection(s). Powered by www.Propertybox.io

Area Map

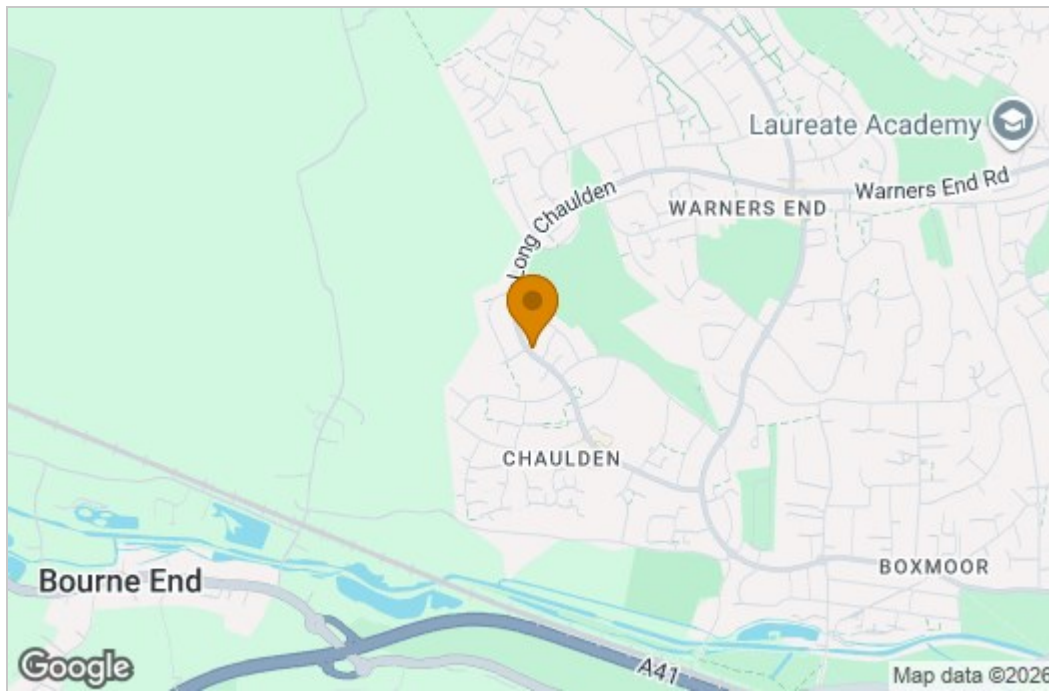

Energy Efficiency Graph

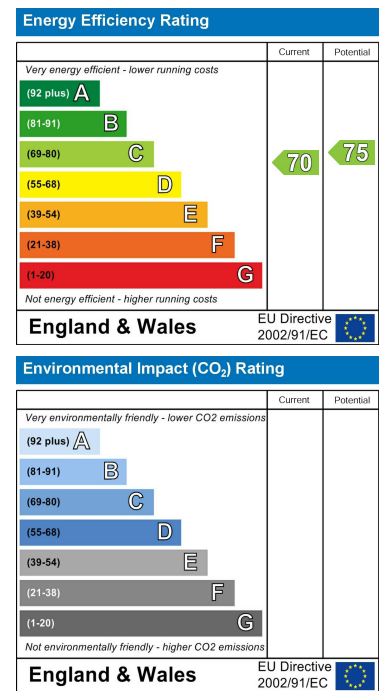

These particulars, whilst believed to be accurate are set out as a general outline only for guidance and do not constitute any part of an offer or contract. Intending purchasers should not rely on them as statements of representation of fact, but must satisfy themselves by inspection or otherwise as to their accuracy. No person in this firm's employment has the authority to make or give any representation or warranty in respect of the property.